

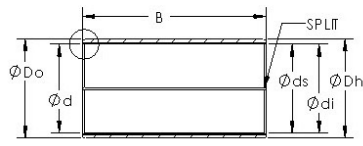

**Linna.**

### AST AST850SM 1610 paliers lisses

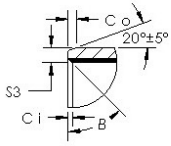

Bearing No. AST850SM 1610

AST850SM 1610 Bearing 2D drawings and 3D CAD models

Bore Diameter	16 mm
Outer Diameter	18 mm
Bearing Type	metal with bronze and graphite
Shaft Dia., Nominal (d)	16.0000
Shaft Size (ds) - 16 +0 / -0.027	16 +0 / 0.027
Housing Bore Dia. (Dh) - 18 +0.018 / -0	18 +0.018 / 0
Bearing Outside Diameter, Nominal(Do)	18.000
Bearing Bore after Mounting (di)	16 +0.148 / +0.010
Average Clearance (Cd)	0.0900
Wall Thickness (S3)	0.965
Bearing Length, Nominal (B)	10.000
Bearing Length Tolerance (B tol.) - +0 / -0.40	+0 / 0.40
OD Chamfer Length (Co)	0.600
ID Chamfer Angle (B deg.)	35
ID Chamfer Length (Ci)	0.300